

### MEGANet Gigabit PoE Unmanaged Switch | 2-Port | Industrial

The MEGANet 2-Port Gigabit PoE Mini Industrial Switch is built for reliable performance in harsh environments. Featuring 2x 10/100/1000M Hi-PoE ports and 2x 1000M SFP uplinks, it ensures stable data transmission and power delivery. With surge and ESD protection, wide temperature tolerance, and a durable IP40-rated aluminium housing, it's ideal for security monitoring and industrial network applications.

#### Features

- Industrial rated device
- Unmanaged device
- 2 x 10/100/1000M Hi-PoE RJ45 Ports – Max 90W per port
- 2 x Gigabit SFP Uplinks – High-speed connectivity
- PoE Auto-Check – Detects & restarts frozen devices
- Relay Alarm – Alerts for power, network, or PoE failure
- Protection – 6KV surge, 6KV contact / 8KV air ESD
- Wide Temp Range – -40°C to 75°C for harsh environments
- Din-Rail Mount – Optimised for industrial use



#### Applications

- Video Surveillance Systems
- Smart City Infrastructure
- Industrial Automation
- Remote Installations

#### Optional

- Power Supply: DC adaptor (48-57V) | Not included, available on request.

#### Warranty

- 2-year limited warranty covering defects in materials or workmanship; excludes improper use, improper installation, natural disasters, and liability is limited to repair or replacement only

#### Technical Specifications

Description	Value
Protection Level	IP40
Power Supply	Powered by DC Power Supply (48-57V)
Power Consumption	Self-consumption < 5W
Downlink Ports	2 x 10/100/1000Base-T   90W PoE RJ45
Uplink Ports	2x 100/1000 SFP
Switching Capacity	8Gbps
Throughput	5.95Mbps
MAC Address Table	8K entries
Buffer Size	1MB
Surge Protection	6KV
ESD Protection	6KV contact / 8KV air
Working Temperature	-40°C to 75°C
Humidity	0% to 95% non-condensing
Dimensions (L x W x H)	101 mm x 65 mm x 36 mm
Weight	300g
Material	Aluminium
Colour	Black

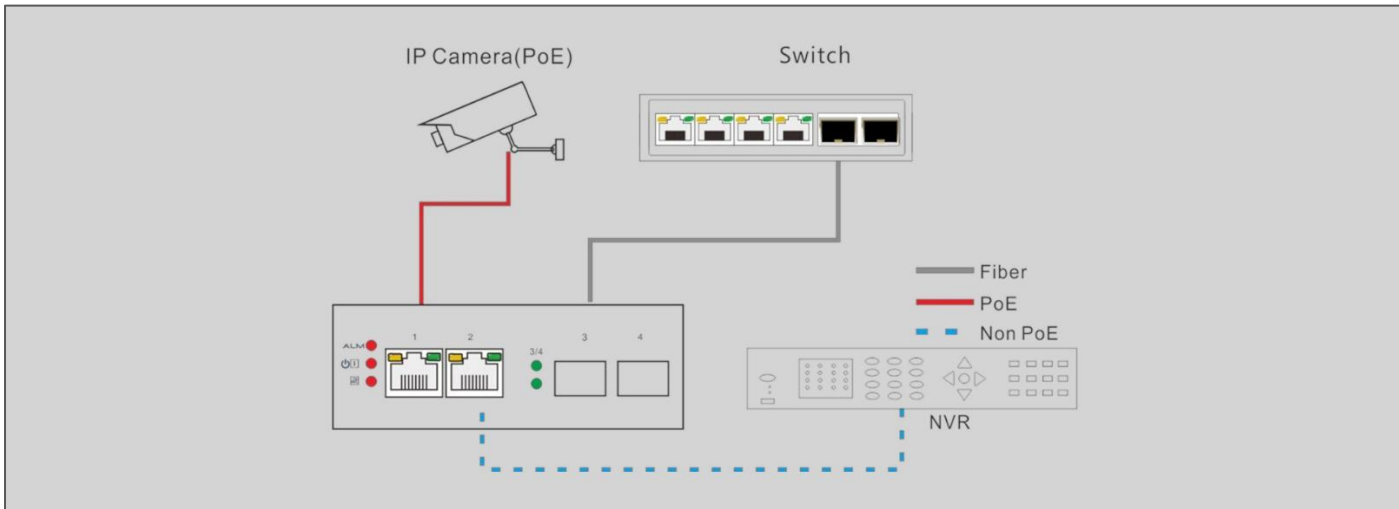

### Panel Diagram

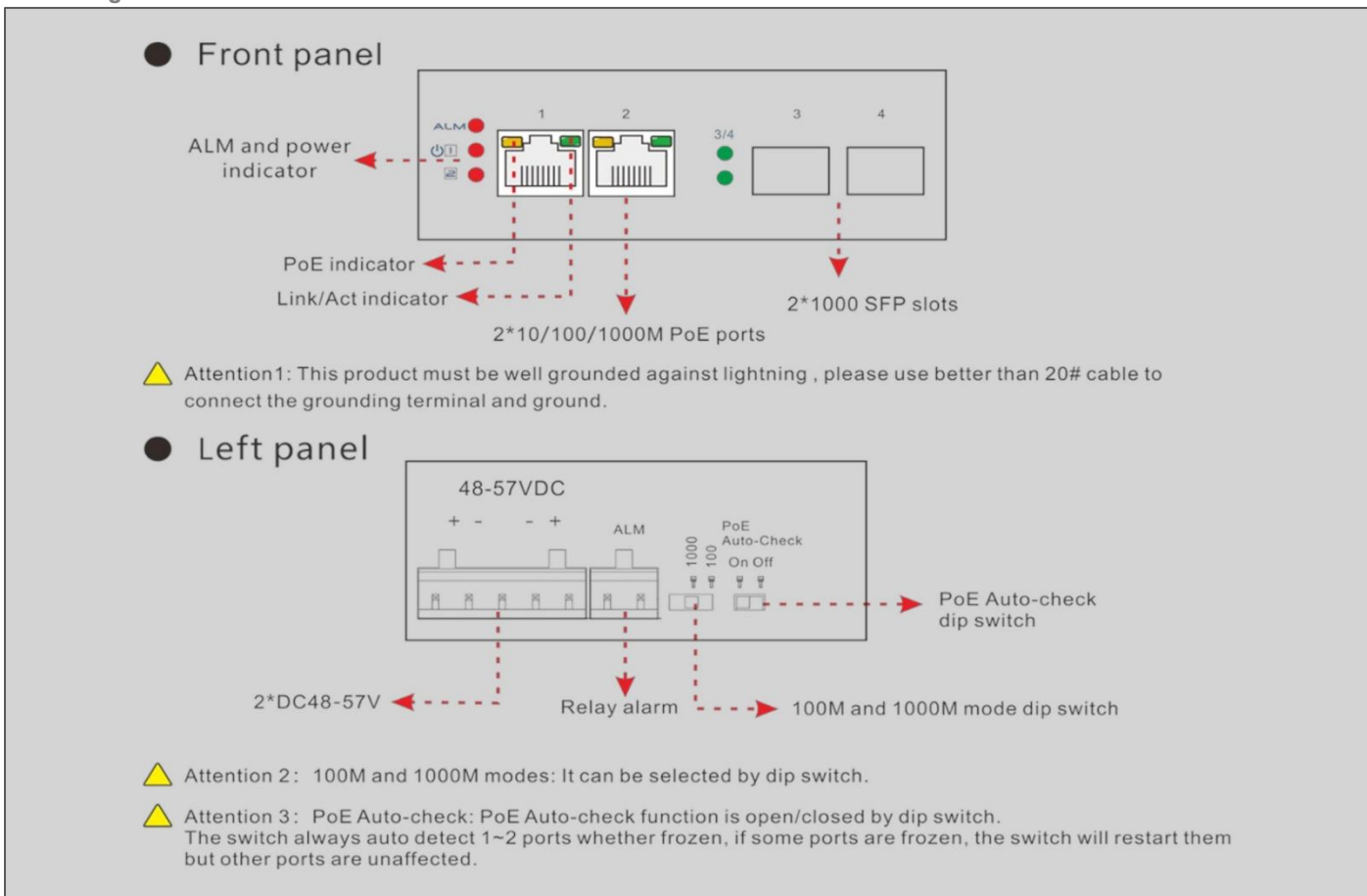

### Order Information

Product Code	Description
A-BT10-B00600	MEGANet Switch   Industrial   Unmanaged   2x 10/100/1000 Hi-PoE(90W)   2x 1Gbps SFP Slot

V 2025/09